

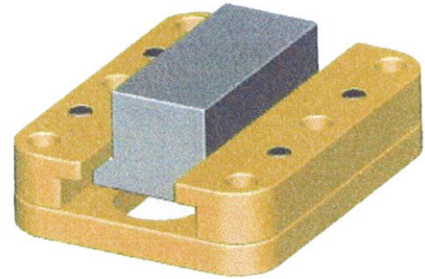

# KTM Mould Components

Canadian Head Office : 295 Alliance Rd Unit #12, Milton, Ont. Canada L9T 4W8



## KTM Gib Assembly

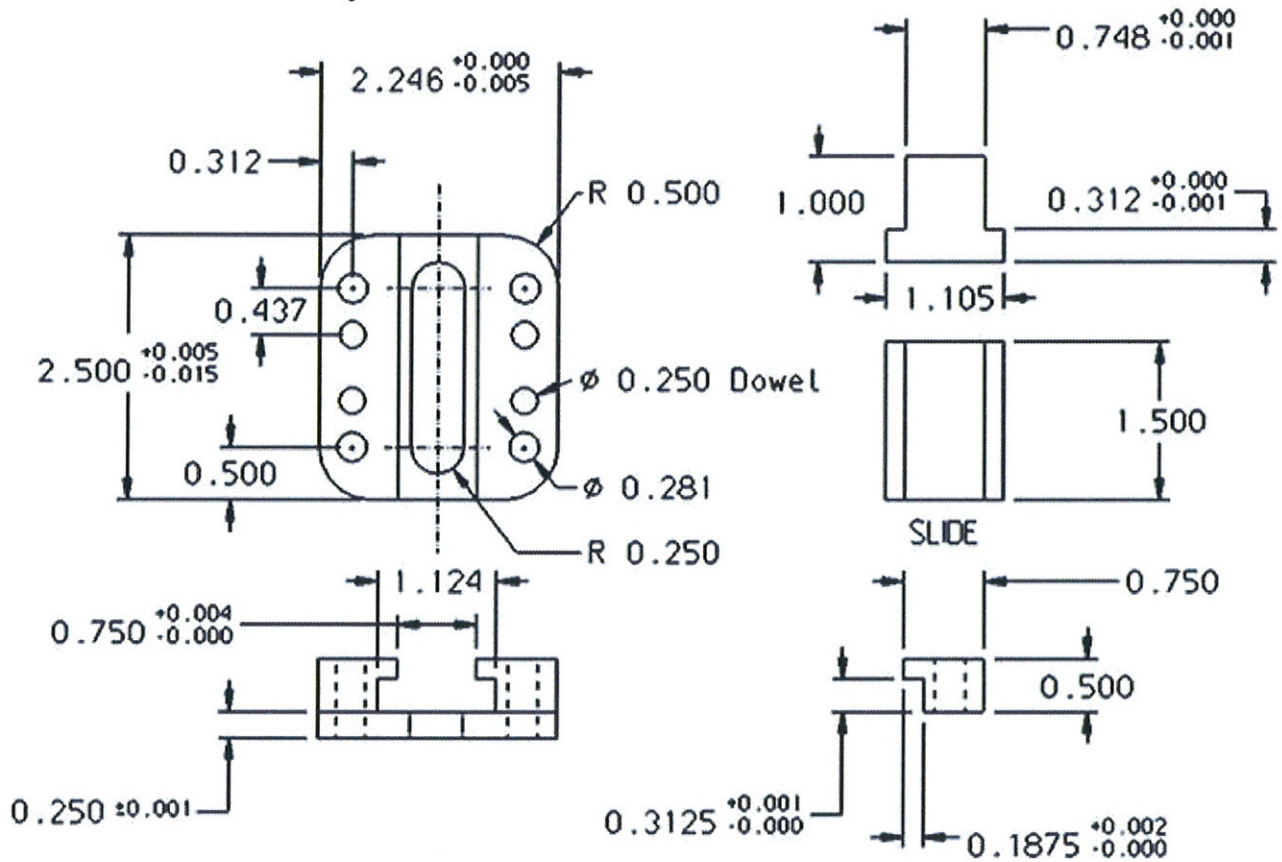

Material:

Gib Assembly: Aluminum Bronze  
Slide: P20

Tolerances: ±0.010 unless otherwise specified

Catalog Number	Description
KT-25	Gib Assembly & Slide
KT-25T	Teflon-Nickel Slide
KT-25A	Gib Assembly (No Slide)
KT-25TA	Gib Assembly & Teflon-Nickel Slide

Features:

- \*Gib Assembly includes:  
2 L-Gibs, 1 Base Plate,  
1 Teflon Nickel coated Slide
- \* Assembly comes pre doweled,  
and predrilled clearance for  
mounting screws.
- \* Base Plate is machined with  
thru hole for ease of assembly.