

# Mold Components

KTM Canada Head Office: 16-342 Bronte St. South, Milton, ON Canada, L9T 5B7  
 Phone: (905) 878-3788 Fax: (905) 878-0900 Email: Info@kingstool.com Website: www.kingstool.com

## KTM Imperial Screw in Core Pin

Material: O1 RC 34-40

Catalogue Name	D +0.000" -0.0006"	THREAD	THREAD DEPTH	RECOMMENDED HEX	B MIN HEIGHT
SCPA-	3/16"	#8-32	0.312"	5/32"	1/4"
SCPB-	1/4"	#10-24	0.450"	5/32"	1/4"
SCPC-	1/4"	#10-24	0.450"	3/16"	1/4"
SCPD-	9/32"	#10-24	0.450"	7/32"	1/4"

Standard Delivery: 2-3 Weeks depending on quantity

**ORDERING USING 3D CAD DATA SAMPLE**

Ordering a Screw in Core Pin with #10-24 Thread with a 5/32 Hex Head made to your 3D Cad file.

Part Name	Your File Name
↓	↓
<b>SCPB</b>	<b>- CORE INSERT CP#1.STP</b>

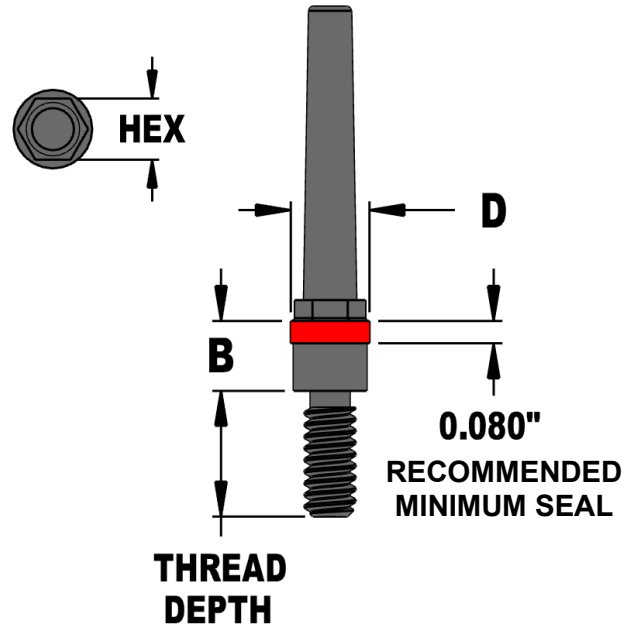

**Custom Made to your specifications. Delivered and ready to be installed.**

**Typical Application for Custom KTM SCREW IN CORE PINS:**

- Capturing boss details with KTM SCREW IN CORE PINS saves time and allows for easy replacement of details in potential wearing locations
- Use KTM SCREW IN CORE Pin in place of Core Pins when there are obstruction such as water lines and lifter rods

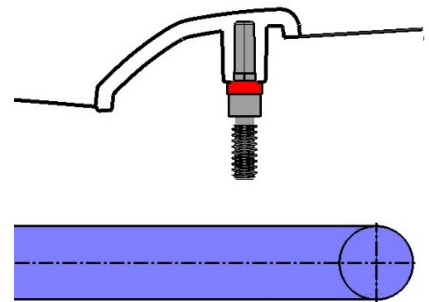

**KTM SCREW IN CORE PINS CAN BE CUSTOMIZED TO YOUR SPECIFICATIONS, SEND US YOUR 3D FILES WITH MATERIAL SPECIFICATIONS**

**Custom Installation tooling can be supplied by KTM. Please Contact KTM for Further**