

KTM CUSTOM IMPERIAL PIN EXTENSIONS

* CUSTOMIZE EXTENSION LENGTH *ADD DOUBLE LOCK SYSTEM *ADD COUNTER BORE INSIDE OF SLEEVE EXTENSION FOR PIN EXTENSION CLEARANCE *CUSTOM GANG EXTENSIONS
ALL EXTENSIONS & DIMENSIONS CAN BE CUSTOMIZED AND TAILOR MADE TO YOUR SPECIFICATION AND DESIGN NEEDS
 KTM Office: (905) 878-3788 Fax: (905) 878-0900 Email: Info@kingstool.com Website: www.kingstool.com

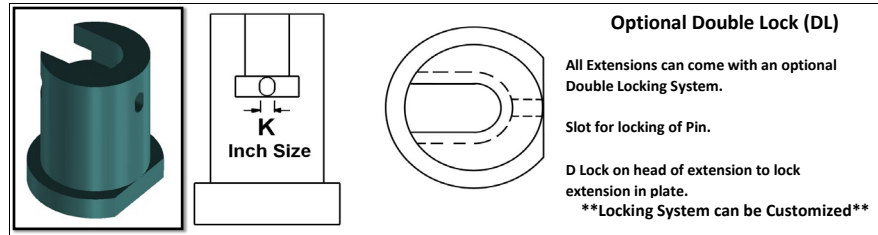
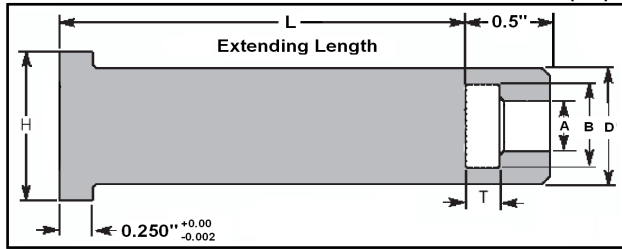

Catalog No. **KTMPE** ****** - **L** - **DL**
 Indicate Extending Length
 Ordering Format

EJP To Be Extended	KTM PIN EXTENSION CAT NO.	L	Optional Double Lock System	Pin Extension Spec					K Inch Size
				D	A	B	T	H	
3/32	KTMPE7	L	Opt. DL	0.5	0.099	0.260	0.126	0.75	0.067
7/64	KTMPE8	L	Opt. DL	0.5	0.114	0.260	0.126	0.75	0.067
1/8	KTMPE9	L	Opt. DL	0.5	0.130	0.260	0.126	0.75	0.067
9/64	KTMPE10	L	Opt. DL	0.5	0.146	0.260	0.126	0.75	0.067
5/32	KTMPE11	L	Opt. DL	0.5	0.161	0.291	0.157	0.75	0.1
11/64	KTMPE12	L	Opt. DL	0.625	0.177	0.354	0.189	0.875	0.1
3/16	KTMPE13	L	Opt. DL	0.625	0.193	0.385	0.189	0.875	0.1
13/64	KTMPE14	L	Opt. DL	0.625	0.208	0.385	0.189	0.875	0.1
7/32	KTMPE15	L	Opt. DL	0.625	0.224	0.416	0.189	0.875	0.1
15/64	KTMPE16	L	Opt. DL	0.625	0.239	0.416	0.189	0.875	0.1
1/4	RKTMPE17	L	Opt. DL	0.625	0.255	0.448	0.189	0.875	0.1
17/64	RKTMPE18	L	Opt. DL	0.625	0.271	0.448	0.251	0.875	0.13
9/32	RKTMPE19	L	Opt. DL	0.625	0.286	0.448	0.251	0.875	0.13
19/64	KTMPE20	L	Opt. DL	0.875	0.302	0.510	0.251	1.125	0.13
5/16	KTMPE21	L	Opt. DL	0.875	0.318	0.510	0.251	1.125	0.13
21/64	KTMPE22	L	Opt. DL	0.875	0.333	0.573	0.251	1.125	0.13
11/32	KTMPE23	L	Opt. DL	0.875	0.349	0.573	0.251	1.125	0.13
23/64	KTMPE24	L	Opt. DL	0.875	0.364	0.635	0.251	1.125	0.13
3/8	KTMPE25	L	Opt. DL	0.875	0.380	0.635	0.251	1.125	0.13
25/64	KTMPE26	L	Opt. DL	0.875	0.396	0.630	0.251	1.125	0.13
13/32	KTMPE27	L	Opt. DL	1	0.411	0.698	0.251	1.25	0.13
27/64	KTMPE28	L	Opt. DL	1	0.427	0.698	0.251	1.25	0.13
7/16	KTMPE29	L	Opt. DL	1	0.443	0.698	0.251	1.25	0.13
29/64	KTMPE30	L	Opt. DL	1	0.458	0.713	0.251	1.25	0.13
15/32	KTMPE31	L	Opt. DL	1	0.474	0.760	0.251	1.25	0.13
31/64	KTMPE32	L	Opt. DL	1	0.489	0.760	0.251	1.25	0.13
1/2	KTMPE33	L	Opt. DL	1	0.505	0.760	0.251	1.25	0.13
17/32	RKTMPE34	L	Opt. DL	1.125	0.536	0.791	0.251	1.375	0.13
9/16	RKTMPE35	L	Opt. DL	1.125	0.568	0.823	0.251	1.375	0.13
5/8	KTMPE37	L	Opt. DL	1.25	0.630	0.885	0.251	1.5	0.13
11/16	KTMPE39	L	Opt. DL	1.25	0.693	0.948	0.251	1.5	0.13
3/4	KTMPE41	L	Opt. DL	1.25	0.755	1.010	0.251	1.5	0.13
7/8	KTMPE45	L	Opt. DL	1.5	0.880	1.135	0.251	1.75	0.13
1	KTMPE47	L	Opt. DL	1.5	1.005	1.260	0.251	1.75	0.13

- Pairing KTM Sleeve Extension
- KTMSE13 & 13B
- KTMSE15 & 15B
- KTMSE17 & 17B
- KTMSE21 & 21B
- KTMSE23 & 23B
- KTMSE25 & 25B
- KTMSE29 & 29B
- KTMSE33 & 33B
- KTMSE37 & 37B
- KTMSE39 & 39B
- KTMSE41 & 41B
- KTMSE45 & 45B
- KTMSE47 & 47B

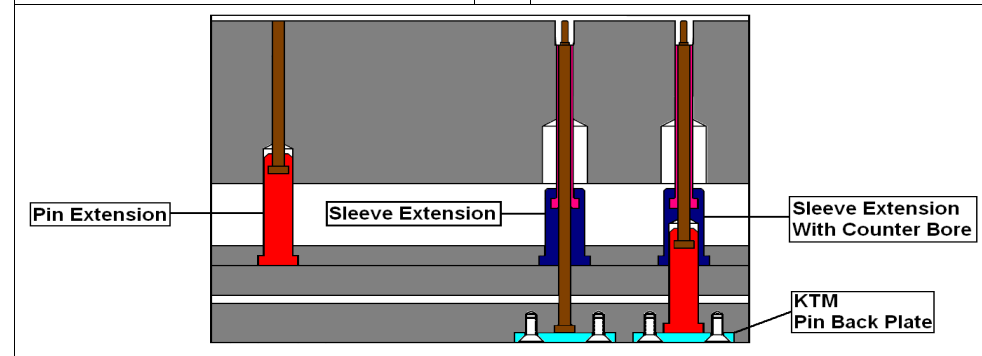
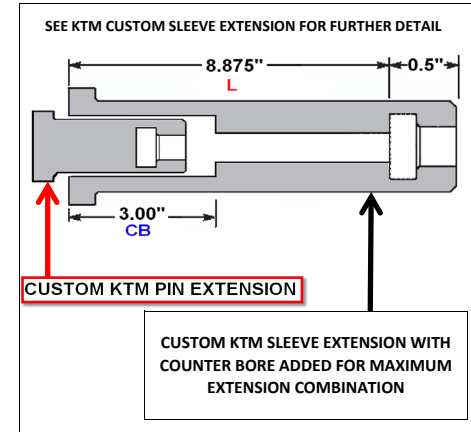
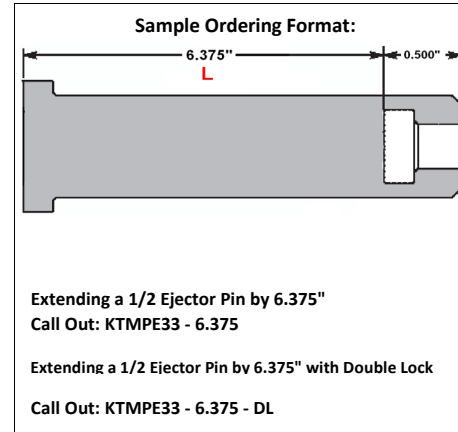

KTM CUSTOM IMPERIAL PIN EXTENSIONS
 Allow 2 1/2 Weeks for Custom Orders. Rush Delivery Available

Contact info@kingstool.com For Further Information.

Custom Metric Pin Extension Available

New Rev as of March 2018

