

KTM IMPERIAL HARDEN NITRIDED EJECTOR PINS

Material: (1.2344, H13, SKD61)

Catalogue Name	(D) Pin Diameter	(H) Head Diameter	(T) Head Thickness	(L) Length
EJP03	3/64	0.250	0.125	Standard & Custom Lengths Available
EJP05	1/16	0.250	0.125	
EJP06	5/64	0.250	0.125	
EJP07	3/32	0.250	0.125	
EJP08	7/64	0.250	0.125	
EJP09	1/8	0.250	0.125	
EJP10	9/64	0.250	0.125	
EJP11	5/32	0.281	0.156	
EJP12	11/64	0.343	0.187	
EJP13	3/16	0.375	0.187	
EJP14	13/64	0.375	0.187	
EJP15	7/32	0.406	0.187	
EJP16	15/64	0.406	0.187	
EJP17	1/4	0.437	0.187	
EJP18	17/64	0.437	0.250	
EJP19	9/32	0.437	0.250	
EJP20	19/64	0.500	0.250	
EJP21	5/16	0.500	0.250	
EJP22	21/64	0.562	0.250	
EJP23	11/32	0.562	0.250	
EJP24	23/64	0.625	0.250	
EJP25	3/8	0.625	0.250	
EJP26	25/64	0.625	0.250	
EJP27	13/32	0.687	0.250	
EJP28	27/64	0.687	0.250	
EJP29	7/16	0.687	0.250	
EJP30	29/64	0.687	0.250	
EJP31	15/32	0.750	0.250	
EJP32	31/64	0.750	0.250	
EJP33	1/2	0.750	0.250	
EJP34	17/32	0.750	0.250	
EJP35	9/16	0.812	0.250	
EJP37	5/8	0.875	0.250	
EJP39	11/16	0.937	0.250	
EJP41	3/4	1.000	0.250	
EJP45	7/8	1.125	0.250	
EJP47	1	1.250	0.250	

Sample Ordering Format:

To order a 1/2" diameter Ejector Pin in 6" inches length:

Catalogue Name (L) Length

EJP33 - 6

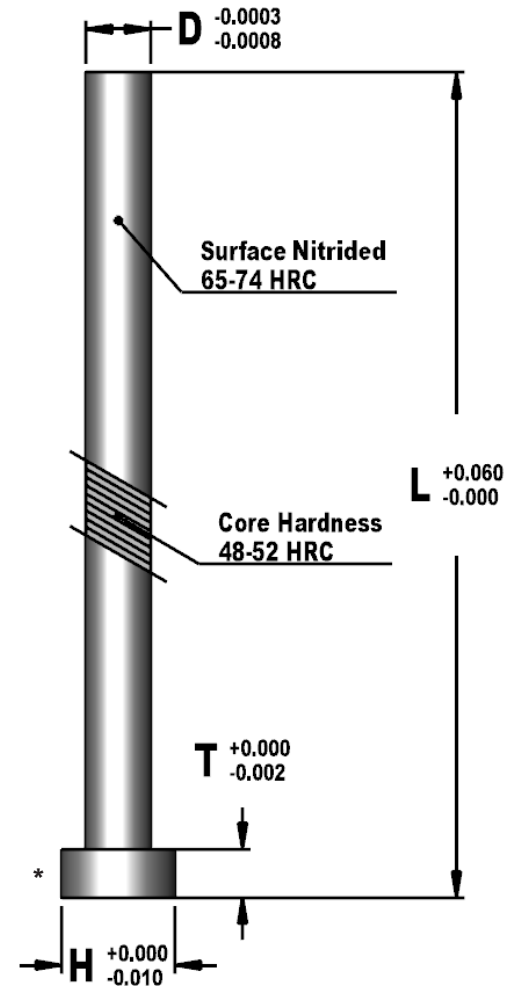

* Bottom of the ejector pin is annealed

Keyed Option Ejector Pin

KTM offers the option to supply ejector pins with anti-rotational flats. Add K after the catalogue name for Keyed ejector pin option.

Catalogue Name Keyed Option (L) Length

EJP33 - K - 6

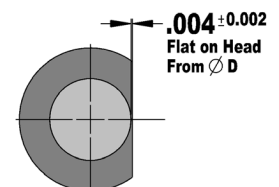

CONTACT KTM FOR CUSTOM EJECTOR PINS & SIZES